

OIL PAN REMOVAL/INSTALLATION [ZJ, Z6]

B3E011110040W01

Warning

- Remove and install all parts when the engine is cold, otherwise they can cause severe burns or serious injury.
- A vehicle that is lifted but not securely supported on safety stands is dangerous. It can slip or fall, causing death or serious injury. Never work around or under a lifted vehicle if it is not securely supported on safety stands.
- Continuous exposure to used engine oil has caused skin cancer in laboratory mice. Protect your skin by washing with soap and water immediately after working with engine oil.

1. Remove the battery cover. (See [BATTERY REMOVAL/INSTALLATION \[ZJ, Z6\]](#).)
2. Disconnect the negative battery cable.
3. Remove the under cover.
4. Drain the engine oil. (See [ENGINE OIL REPLACEMENT \[ZJ, Z6\]](#).)
5. Remove in the order indicated in the table.

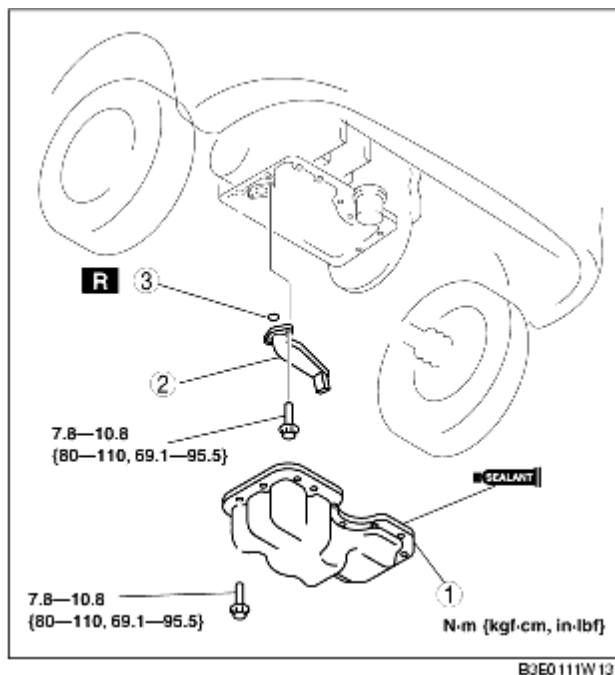

1	Oil pan (See Oil Pan Removal Note .) (See Oil Pan Installation Note .)
2	Oil strainer
3	O-ring

6. Install in the reverse order of removal.

7. Add engine oil. (See [ENGINE OIL REPLACEMENT \[ZJ, Z6\]](#).)
8. Start the engine and confirm that there is no oil leakage from areas worked on.
 - If there is oil leakage, find the cause and repair or replace the applicable part.
9. Inspect the oil level. (See [ENGINE OIL LEVEL INSPECTION \[ZJ, Z6\]](#).)
10. Install the under cover.

Oil Pan Removal Note

1. Remove the oil pan using the separator tool.

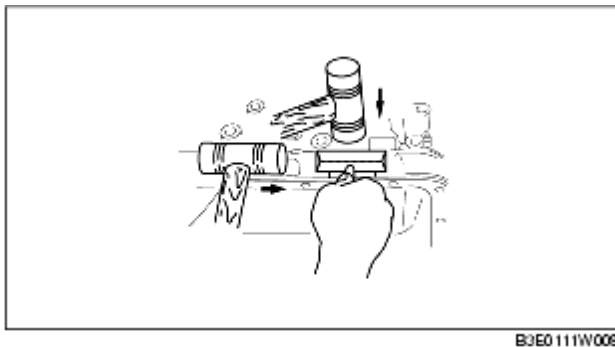

Oil Pan Installation Note

Caution

- Apply the silicon sealant in a single, unbroken line around the whole perimeter.
- Install the oil pan within 5 min after applying the silicone sealant.
- Using bolts with the seal adhering could cause cracks in the housing.

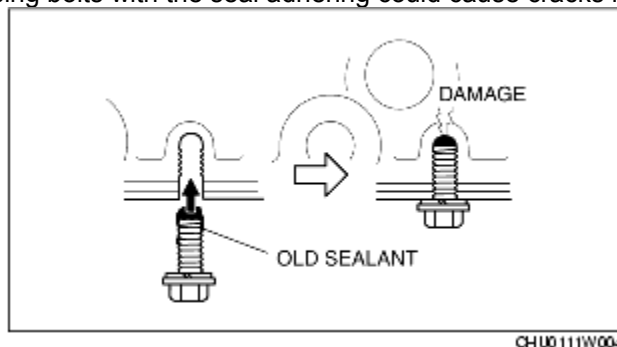

1. Completely clean and remove any oil, dirt, sealant or other foreign material that may be adhering to the housing and oil pan.
2. When reusing oil pan installation bolts, clean any old sealant from the bolts.
3. Apply silicone sealant to the areas shown in the figure.

Thickness**2.06.0 mm {0.080.24 in}**

4. Tighten the bolts in the order as shown in the figure.

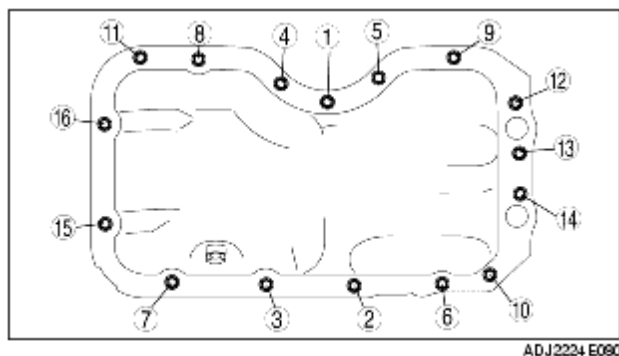

ADJ2224 E080

Tightening torque**7.810.8 N·m {80-110 kgf·cm, 69.1-95.5 in·lbf}**